

MINIMOTOR - PAE - COAXIAL GEAR MOTOR WITH ADITIONAL PLANETARY GEAR

PAE 140M2TB3-16.5
230/400V 3 ph 16.5rpm 18 Nm B3 mount



- Single or three phase
- 34 to 180W delivered power
- Up to 90Nm rated torque
- B3 foot or B5 flange mounting
- IP65 as standard

PRODUCT DESCRIPTION

High quality, designed from the ground up to IP65 rated compact gear motor.

Physically smaller than the majority of similar powered gear motors due to the use of high quality components in precision manufacturing.

Ideally suited to many applications, including label and packaging machines, conveyors, pharmaceutical and medical machinery

MOTOR: Asynchronous single or three phase with 2 or 4 poles, totally enclosed with external ventilation. Thermal safety cutout on single phase model. Class F winding. IP65 protection according to CEI EN 60529.

GEAR UNIT: First stage with die-cast aluminium casing, second stage in steel. Case-hardened and hardened gear pairs with shafts rotating on roller bearings. Lubrication with long life oil. Sealing rings made in special rubber for high temperatures. 13 gear ratios (i) available, from 48.7 to 1770.9. Rated torque 90 Nm. Version B3 or B5.

[Please click here for 2D and 3D drawings](#)

TECHNICAL DATA

Input voltage ac	230/400V
Nominal speed	16,5 rpm
Nominal torque	18 Nm
Output power	38 W
Rated current	0.33Δ/0.19Y A
Ratio	83.6:1

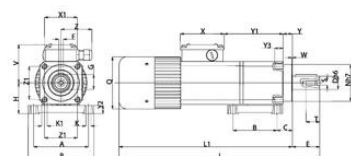

B3

Motor Type	A	B	C	D	E	F	G	H	K	K1	L	L1	N	O	R	S	T	V	X	X1	Y	Y1	Y2	Y3	Z	Z1	Motor Output Power (W)
PAE_M2	100	80	28	24	50	8	27	56	9	M10367317	67	85	120	M8	22	71	80	60	17	198	13	15	1	56	60	6,990	
PAE_M3	100	80	28	24	50	8	27	56	9	M10369242	67	85	120	M8	22	71	80	60	17	198	13	15	1	56	60	7,750	

Mini motor selection



E230C motor
15.06.2017



Gearbox motor
15.06.2017



Worm gear motor
15.06.2017



Brushless servomotor
15.06.2017



Clean product
15.06.2017



Other

Please see product description above for 2D and 3D drawings

