

## JUNG HYGHSPIN EXTENDED SERIES PUMP

Hygienic twin screw pump

JPS HYGHSPIN 125E

- Flow 100l/h to 350m³/h
- Pressure up to 6 bar
- Viscosity up to 1,000,000 cSt
- Temperature -10°C to +130°C (180°C)
- Max. particle size 67mm

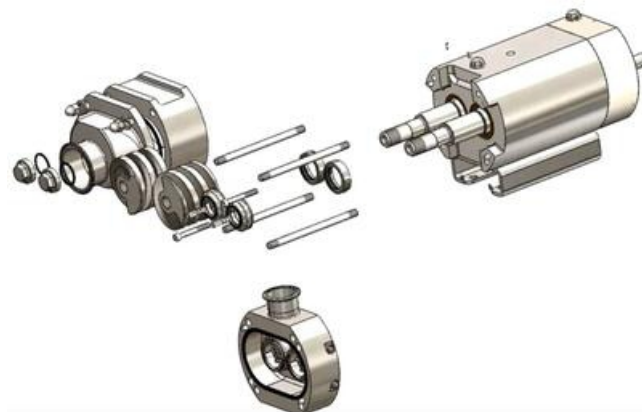

### PRODUCT DESCRIPTION

The HYGHSPIN Extended is a variant of the worldwide tried and tested HYGHSPIN pump series made of high-quality stainless steel. The special focus for the HYGHSPIN Extended is on applications in the low-pressure range of up to 6 bar differential pressure.

The feed screws and the pump housing are extended. The HYGHSPIN Extended therefore expands the application possibilities for the individual sizes for higher volume flow rates or very large solids.

The HYGHSPIN Extended stands for high performance with compact dimensions. It is available in block design or with free shaft end.

### TECHNICAL DATA

Connection type	Different sizes and connector standards by arrangement
Differential pressure	6 bar
Flow max	300 m³/h
Material of elastomers	EPDM, FPM, HNBR (Nitrile rubber), FFPM
Material of wetted parts	Stainless steel 316/316L (1.4401/1.4404), Stainless steel 1.4462, 1.4404, Stainless Steel 1.4539
Maximum diameter of solid material	67 mm
Pump orientation	Horizontal, vertical or lateral
Temperature operational max	180 °C
Temperature operational min	-10 °C
Viscosity	0.5 - 1,000,000 mPas

Mått HYGHSPN Extended fl axel (mm)

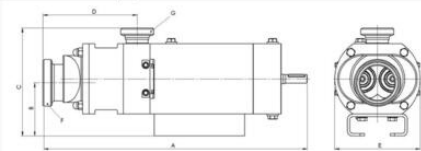

Pumpstorlek	A	B	C	D	E	G (Radiell)	H (Axell)	Vikt (kg)
Hyghespin 70E	655	124	252	249	199	DN40-DN80 (1,5"-3")	DN40-DN100 (1,5"-4")	65
Hyghespin 90E	788	146	342	340	259	DN60-DN100 (2"-4")	DN60-DN125 (2"-5")	128
Hyghespin 120E	1094	212	491	370	249	DN65-DN150 (2,5"-6")	DN65-DN150 (2"-6")	365

Mått HYGHSPN Extended kompaktsmonterad (mm)

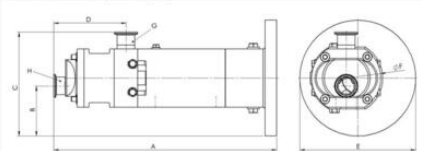

Pumpstorlek	A	B	C	D	E	F	G (Radiell)	H (Axell)	Vikt (kg)
Hyghespin 70E	690	200	295	249	350	199	DN40-DN80 (1,5"-3")	DN40-DN100 (1,5"-4")	68
Hyghespin 90E	850	140	334	340	350	259	DN60-DN100 (2"-4")	DN60-DN125 (2"-5")	150

Mått HYGHSPN Extended fl axel (mm)

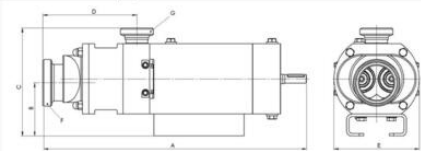

Pumpstorlek	A	B	C	D	E	G (Radiell)	H (Axell)	Vikt (kg)
Hyghespin 70E	655	124	252	249	199	DN40-DN80 (1,5"-3")	DN40-DN100 (1,5"-4")	65
Hyghespin 90E	788	146	342	340	259	DN60-DN100 (2"-4")	DN60-DN125 (2"-5")	128
Hyghespin 120E	1094	212	491	370	249	DN65-DN150 (2,5"-6")	DN65-DN150 (2"-6")	365

Mått HYGHSPN Extended kompaktsmonterad (mm)

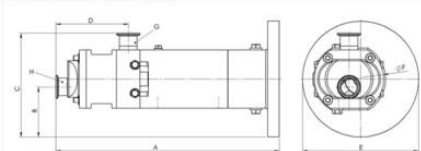

Pumpstorlek	A	B	C	D	E	F	G (Radiell)	H (Axell)	Vikt (kg)
Hyghespin 70E	690	200	295	249	350	199	DN40-DN80 (1,5"-3")	DN40-DN100 (1,5"-4")	68
Hyghespin 90E	850	140	334	340	350	259	DN60-DN100 (2"-4")	DN60-DN125 (2"-5")	150