

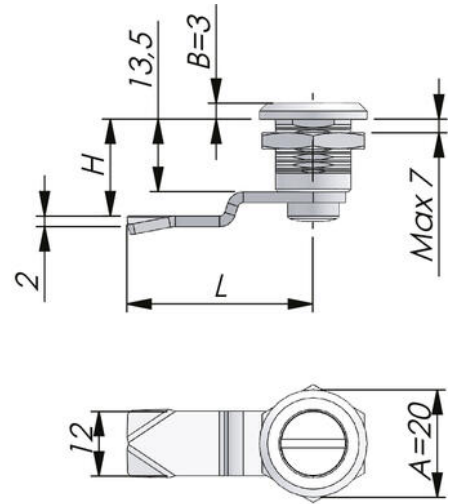

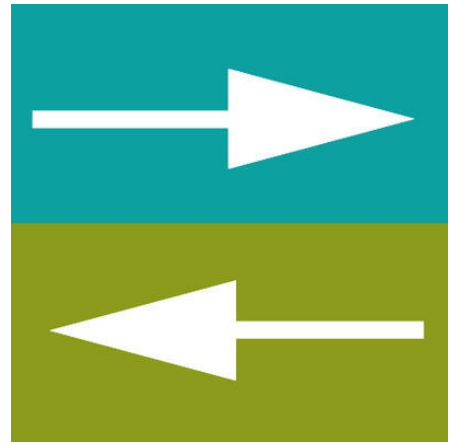

IP65



| Skrav och delar för kompletteringen till 12,3 mm (AAA-RÖDLED-CCG) |                         |         |       |           |         |       |          |         |       |
|---|-------------------------|---------|-------|-----------|---------|-------|----------|---------|-------|
| 2424  | 2425                    | 2426    | 2427  | 2428      | 2429    | 2430  | 2431     | 2432    | 2433  |
| Del   | Material                | Storlek | Antal | Material  | Storlek | Antal | Material | Storlek | Antal |
| 2424  | Zink-nickelmat A=20 B=3 | 2       | 20    | Zinkmat A | 2       | 20    | 2424     | 12,3    | 1     |
| 2426  | Zink-nickel A=20 B=3    | 2       | 20    | Zinkmat A | 2       | 20    | 2426     | 12,3    | 1     |
|   |                         |         |       | Zinkmat B | 2       | 20    | 2427     | 12,3    | 1     |
|   |                         |         |       | Zinkmat C | 2       | 20    | 2428     | 12,3    | 1     |
|   |                         |         |       | Zinkmat D | 2       | 20    | 2429     | 12,3    | 1     |
|   |                         |         |       | Zinkmat E | 2       | 20    | 2430     | 12,3    | 1     |
|   |                         |         |       | Zinkmat F | 2       | 20    | 2431     | 12,3    | 1     |
|   |                         |         |       | Zinkmat G | 2       | 20    | 2432     | 12,3    | 1     |
|   |                         |         |       | Zinkmat H | 2       | 20    | 2433     | 12,3    | 1     |
|   |                         |         |       | Zinkmat I | 2       | 20    | 2434     | 12,3    | 1     |
|   |                         |         |       | Zinkmat J | 2       | 20    | 2435     | 12,3    | 1     |
|   |                         |         |       | Zinkmat K | 2       | 20    | 2436     | 12,3    | 1     |
|   |                         |         |       | Zinkmat L | 2       | 20    | 2437     | 12,3    | 1     |
|   |                         |         |       | Zinkmat M | 2       | 20    | 2438     | 12,3    | 1     |
|   |                         |         |       | Zinkmat N | 2       | 20    | 2439     | 12,3    | 1     |
|   |                         |         |       | Zinkmat O | 2       | 20    | 2440     | 12,3    | 1     |
|   |                         |         |       | Zinkmat P | 2       | 20    | 2441     | 12,3    | 1     |
|   |                         |         |       | Zinkmat Q | 2       | 20    | 2442     | 12,3    | 1     |
|   |                         |         |       | Zinkmat R | 2       | 20    | 2443     | 12,3    | 1     |
|   |                         |         |       | Zinkmat S | 2       | 20    | 2444     | 12,3    | 1     |
|   |                         |         |       | Zinkmat T | 2       | 20    | 2445     | 12,3    | 1     |
|   |                         |         |       | Zinkmat U | 2       | 20    | 2446     | 12,3    | 1     |
|   |                         |         |       | Zinkmat V | 2       | 20    | 2447     | 12,3    | 1     |
|   |                         |         |       | Zinkmat W | 2       | 20    | 2448     | 12,3    | 1     |
|   |                         |         |       | Zinkmat X | 2       | 20    | 2449     | 12,3    | 1     |
|   |                         |         |       | Zinkmat Y | 2       | 20    | 2450     | 12,3    | 1     |
|   |                         |         |       | Zinkmat Z | 2       | 20    | 2451     | 12,3    | 1     |

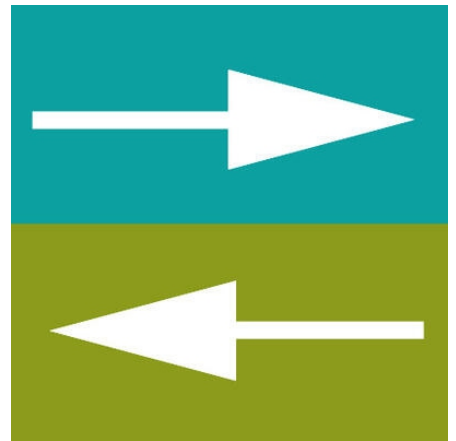
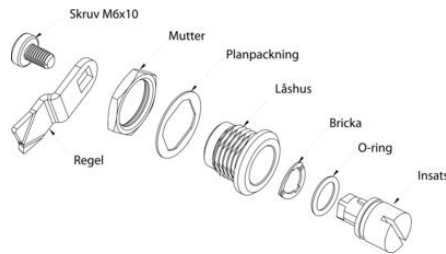



IP65

