

KUEBLER - ABSOLUTE-CODED ANGULAR TRANSMITTER SENDIX 5858/5878, OPTICAL, CANOPEN, Ø58M SERIE 5858 CANOPEN

- Housing diameter Ø58 mm
- CANopen
- Safety-Lock™
- High degree of enclosure



PRODUCT DESCRIPTION

Sendix 5858/5878 is a one-way fieldbus transducer with CANopen in robust design. Thanks to the construction of Safety-Lock™ as well as the fully cast housing, the sensor is able to handle even the more demanding applications where there are high demands on the sensor. The wide temperature range combined with the high enclosure class allows the sensor to be used outdoors as well as applications where large temperature changes occur. Sendix 5858/5878 is available with LED indication, which facilitates diagnosis of the sensor and a set button that facilitates calibration.

Please refer to the images below for ordering information.

Order code	8.5858 . XX2X . 211X						
Shaft version	Type	a	b	c	d	e	f
a Flange		1 = clamping flange, IP65 ø 58 mm [2.28"]			d Type of connection removable bus terminal cover		e Fieldbus profile
		3 = clamping flange, IP67 ø 58 mm [2.28"]			1 = radial cable gland		21 = CANopen
		2 = synchro flange, IP65 ø 58 mm [2.28"]			2 = 2 x M12 connector, 5-pin		f Options (service)
		4 = synchro flange, IP67 ø 58 mm [2.28"]			Fixed connection without bus terminal cover		2 = no options
		5 = square flange, IP65 □ 63.5 mm [2.5"]			A = radial cable, 2 m [6.56'] PVC		3 = SET button
		7 = square flange, IP67 □ 63.5 mm [2.5"]			B = radial cable, special length PVC *)		Optional on request
b Shaft (ø x L), with flat					E = 1 x radial M12 connector, 5-pin		- Ex 2/22 ³⁾
		1 = 6 x 10 mm [0.24 x 0.39"] ¹⁾			F = 2 x radial M12 connector, 5-pin		- surface protection
		2 = 10 x 20 mm [0.39 x 0.79"] ²⁾			I = 1 x radial M23 connector, 12-pin		salt spray tested
		3 = 1/4" x 7/8"			J = 2 x radial M23 connector, 12-pin		
		4 = 3/8" x 7/8"					
c Interface / power supply					*) Available special lengths (connection type B):		
		2 = CANopen DS301 V4.02 / 10 ... 30 V DC			3, 5, 8, 10, 15 m [9.84, 16.40, 26.25, 32.80, 49.21']		
					order code expansion .XXXX = length in dm		
					ex.: 8.5858.112B.2113.0030 (for cable length 3 m)		

Order code
Hollow shaft

8.5878
Type

. X X 2 X . 21 1 X
a b c d e f

a Flange

- 1 = with spring element, long, IP65
- 2 = with spring element, long, IP67
- 3 = with stator coupling, IP65 ø 65 mm [2.56"]
- 4 = with stator coupling, IP67 ø 65 mm [2.56"]
- 5 = with stator coupling, IP65 ø 63 mm [2.48"]**
- 6 = with stator coupling, IP67 ø 63 mm [2.48"]

b Blind hollow shaft

- (insertion depth max. 30 mm [1.18"])
- 3 = ø 10 mm [0.39"]
 - 4 = ø 12 mm [0.47"]**
 - 5 = ø 14 mm [0.55"]
 - 6 = ø 15 mm [0.59"]
 - 8 = ø 3/8"
 - 9 = ø 1/2"

c Interface / power supply

- 2 = CANopen DS301 V4.02 / 10 ... 30 V DC**

d Type of connection

- removable bus terminal cover
- 1 = radial cable gland
 - 2 = 2 x M12 connector, 5-pin**
Fixed connection without bus terminal cover
 - A = radial cable, 2 m [6.56'] PVC
 - B = radial cable, special length PVC *)
 - E = 1 x radial M12 connector, 5-pin
 - F = 2 x radial M12 connector, 5-pin
 - I = 1 x radial M23 connector, 12-pin
 - J = 2 x radial M23 connector, 12-pin
- *) Available special lengths (connection type B):
3, 5, 8, 10, 15 m [9.84, 16.40, 26.25, 32.80, 49.21']
order code expansion .XXXX = length in dm
ex.: 8.5878.542B.2113.0030 (for cable length 3 m)

e Fieldbus profile

- 21 = CANopen**

f Options (service)

- 2 = no options
 - 3 = SET button**
- Optional on request
- Ex 2/22 ¹⁾
 - surface protection salt spray tested

TECHNICAL DATA

Connection	Cable, M12, M23 contact
Housing diameter	58 mm
IP class	IP65, IP67
Mounting	Shoulder
Output	CANopen
Sensor type	Absolute
Shaft diameter max	10 mm
Shaft diameter min	6 mm
Supply voltage dc max	30 V DC
Supply voltage dc min	10 V DC
Temperature operational max	80 °C
Temperature operational min	-40 °C
Version	Singleturn

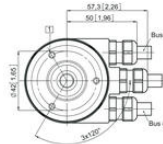
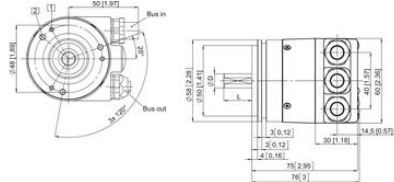
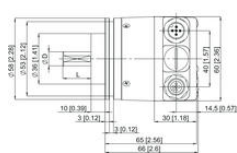

Bus terminal cover with terminal box (type of connection 1)

Direction	OUT				IN					
Signal	CAN_Ground	CAN_Low (1)	CAN_High (1)	0V power supply	+16 power supply	0V power supply	+16 power supply	CAN_Low (1)	CAN_High (1)	CAN_Ground
Abbreviation	CG	CL	CH	0V	+16	0V	+16	CL	CH	CG

Cable connection type (connection A)

Direction	IN				Bus in and out M23				
Signal	0V power supply	+16 power supply	CAN_Low (1)	CAN_High (1)	CAN_Ground				
Abbreviation	0V	+16	CL	CH	CG				
Cable colour	WH	BN	YE	GN	GY				

Connector M23 (type of connection 2 or M12 type of connection E)

Direction	IN				Bus out				
Signal	0V power supply	+16 power supply	CAN_Low (1)	CAN_High (1)	CAN_Ground				
Abbreviation	0V	+16	CL	CH	CG				
M23 PIN assignment	10	12	2	7	3				
M12 PIN assignment	3	2	5	4	1				

Bus terminal cover with Connectors 2 x M12 (type of connection 2, F or J)

Direction	OUT				IN					
Signal	CAN_Ground	CAN_Low (1)	CAN_High (1)	0V power supply	+16 power supply	0V power supply	+16 power supply	CAN_Low (1)	CAN_High (1)	CAN_Ground
M23 PIN assignment	3	2	7	10	12	7	10	2	7	3
M12 PIN assignment	1	5	4	3	2	3	2	5	4	1