

# KUEBLER - ABSOLUTE-CODED ANGULAR TRANSMITTER SENDIX 5858/5878, OPTICAL, ETHERCAT, Ø58 MM

SERIE 5858 ETHERCAT

- Housing diameter Ø58 mm
- EtherCAT
- Safety-Lock™
- High enclosure class



## PRODUCT DESCRIPTION

Sendix 5858/5878 is a one-way fieldbus transducer with EtherCAT in robust design. Thanks to the construction of Safety-Lock™ as well as the fully cast housing, the sensor is able to handle even the more demanding applications where there are high demands on the sensor. The wide temperature range combined with the high enclosure class allows the sensor to be used outdoors as well as applications where large temperature changes occur. Sendix 5858/5878 is available with LED indication, which facilitates diagnosis of the sensor and a set button that facilitates calibration.

Please refer to the image below for ordering information.

Order code Shaft version	8.5858 Type	. XXB2 . a b c d	B2 12 e	
<b>a</b> Flange	<b>1 = clamping flange, IP65 ø 58 mm [2.28"]</b> 3 = clamping flange, IP67 ø 58 mm [2.28"] <b>2 = synchro flange, IP65 ø 58 mm [2.28"]</b> 4 = synchro flange, IP67 ø 58 mm [2.28"] 5 = square flange, IP65 □ 63.5 mm [2.5"] 7 = square flange, IP67 □ 63.5 mm [2.5"]	<b>b</b> Shaft (ø x L), with flat <b>1 = 6 x 10 mm [0.24 x 0.39"]<sup>1)</sup></b> <b>2 = 10 x 20 mm [0.39 x 0.79"]<sup>2)</sup></b> 3 = 1/4" x 7/8" 4 = 3/8" x 7/8"	<b>c</b> Interface / power supply <b>B = EtherCAT / 10 ... 30 V DC</b>	<b>e</b> Fieldbus profile <b>B2= EtherCAT with CoE (CAN over EtherNet)</b>
<b>d</b> Type of connection removable bus terminal cover	<b>2 = 3 x M12 connector, 4-pin</b>	Optional on request - Ex 2/22 - surface protection salt spray tested		

Order code Hollow shaft	8.5878 Type	. XXB2 . a b c d	B2 12 e	
<b>a</b> Flange	<b>1 = with spring element, long, IP65</b> 2 = with spring element, long, IP67 3 = with stator coupling, IP65 ø 65 mm [2.56"] 4 = with stator coupling, IP67 ø 65 mm [2.56"] <b>5 = with stator coupling, IP65 ø 63 mm [2.48"]</b> 6 = with stator coupling, IP67 ø 63 mm [2.48"]	<b>b</b> Blind hollow shaft (insertion depth max. 30 mm [1.18"]) 3 = ø 10 mm [0.39"] <b>4 = ø 12 mm [0.47"]</b> 5 = ø 14 mm [0.55"] 6 = ø 15 mm [0.59"] 8 = ø 3/8" 9 = ø 1/2"	<b>c</b> Interface / power supply <b>B = EtherCAT / 10 ... 30 V DC</b>	<b>e</b> Fieldbus profile <b>B2= EtherCAT with CoE (CAN over EtherNet)</b>
<b>d</b> Type of connection removable bus terminal cover	<b>2 = 3 x M12 connector, 4-pin</b>	Optional on request - Ex 2/22 - surface protection salt spray tested		

## TECHNICAL DATA

Connection	M12
Housing diameter	58 mm
IP class	IP65, IP67

<b>Mounting</b>	Shoulder
<b>Output</b>	EtherCAT
<b>Sensor type</b>	Absolute
<b>Shaft diameter max</b>	10 mm
<b>Shaft diameter min</b>	6 mm
<b>Supply voltage dc max</b>	30 V DC
<b>Supply voltage dc min</b>	10 V DC
<b>Temperature operational max</b>	80 °C
<b>Temperature operational min</b>	-40 °C
<b>Version</b>	Singleturn

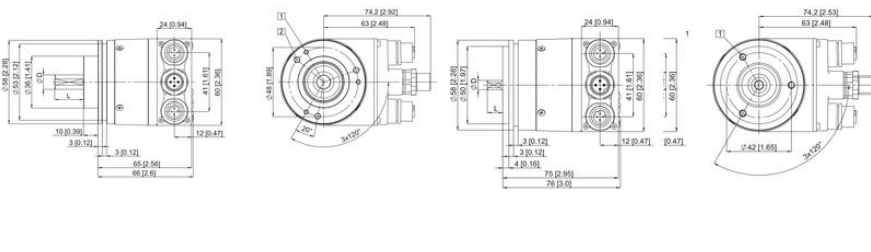

Type of connection: 2-Droped

Direction	Port A				Port B			
	Transmit data	Receive data	Transmit data	Receive data	Transmit data	Receive data	Transmit data	Receive data
Abbreviation	TA0V	RA0V	TA0C	RA0C	TA0V	RA0V	TA0C	RA0C
M12 PIN assignment	1	2	3	4	1	2	3	4

Port A and B

Terminal assignment power supply

Signal	+15V power supply	n.c.	0V	n.c.
Abbreviation	+15V	-	0V	-
M12 PIN assignment	1	2	3	4