

# KUEBLER - ABSOLUTE-CODED ANGULAR TRANSMITTER SENDIX 5858/5878, OPTICAL, PROFIBUS, Ø58 MM

SERIE 5858 PROFIBUS

- Housing diameter Ø58 mm
- Profibus
- Safety-Lock™
- High enclosure class



## PRODUCT DESCRIPTION

Sendix 5858/5878 is a one-way fieldbus sensor with Profibus in robust design. Thanks to the construction of Safety-Lock™ as well as the fully cast housing, the sensor is able to handle even the more demanding applications where there are high demands on the sensor. The wide temperature range combined with the high enclosure class allows the sensor to be used outdoors as well as applications where large temperature changes occur. Sendix 5858/5878 is available with LED indication, which facilitates diagnosis of the sensor and a set button that facilitates calibration.

Please refer to the images below for ordering information.

Order code	8.5858	.XX3X.	311X	
Shaft version	Type	a b c d	e f	
<b>a</b> Flange	<b>1 = clamping flange, IP65 ø 58 mm [2.28"]</b> 3 = clamping flange, IP67 ø 58 mm [2.28"] <b>2 = synchro flange, IP65 ø 58 mm [2.28"]</b> 4 = synchro flange, IP67 ø 58 mm [2.28"] 5 = square flange, IP65 □ 63.5 mm [2.5"] 7 = square flange, IP67 □ 63.5 mm [2.5"]	<b>b</b> Shaft (ø x L), with flat <b>1 = 6 x 10 mm [0.24 x 0.39"]<sup>1)</sup></b> <b>2 = 10 x 20 mm [0.39 x 0.79"]<sup>2)</sup></b> 3 = 1/4" x 7/8" 4 = 3/8" x 7/8"	<b>d</b> Type of connection removable bus terminal cover 1 = with radial cable gland fitting <b>2 = with 3 x radial M12 connectors</b>	<b>f</b> Options (Service) 2 = no option <b>3 = SET button</b>  Optional on request - Ex 2/22 - surface protection salt spray tested
		<b>c</b> Interface / power supply <b>3 = PROFIBUS DP V0</b> encoder profile V 1.1, 10 ... 30 V DC	<b>e</b> Fieldbus profile <b>31 = PROFIBUS DP V0</b> encoder profile class 2	

Order code	8.5878	.XX3X.	311X
Hollow shaft	Type	a b c d	e f
<b>a</b> Flange 1 = with spring element, long, IP65 2 = with spring element, long, IP67 3 = with stator coupling, IP65 ø 65 mm [2.56"] 4 = with stator coupling, IP67 ø 65 mm [2.56"] <b>5 = with stator coupling, IP65 ø 63 mm [2.48"]</b> 6 = with stator coupling, IP67 ø 63 mm [2.48"]	<b>b</b> Blind hollow shaft (insertion depth max. 30 mm [1.18"]) 3 = ø 10 mm [0.39"] <b>4 = ø 12 mm [0.47"]</b> 5 = ø 14 mm [0.55"] 6 = ø 15 mm [0.59"] 8 = ø 3/8" 9 = ø 1/2"	<b>d</b> Type of connection removable bus terminal cover 1 = with radial cable gland fitting <b>2 = with 3 x radial M12 connectors</b>	<b>f</b> Options (Service) 2 = no option <b>3 = SET button</b>  Optional on request - Ex 2/22 - surface protection salt spray tested
	<b>c</b> Interface / power supply <b>3 = PROFIBUS DP V0</b> encoder profile V 1.1, 10 ... 30 V DC	<b>e</b> Fieldbus profile <b>31 = PROFIBUS DP V0</b> encoder profile class 2	

## TECHNICAL DATA

Connection

Cable, M12

<b>Housing diameter</b>	58 mm
<b>IP class</b>	IP65, IP67
<b>Mounting</b>	Shoulder
<b>Output</b>	Profibus
<b>Sensor type</b>	Absolute
<b>Shaft diameter max</b>	10 mm
<b>Shaft diameter min</b>	6 mm
<b>Supply voltage dc max</b>	30 V DC
<b>Supply voltage dc min</b>	10 V DC
<b>Temperature operational max</b>	80 °C
<b>Temperature operational min</b>	-40 °C
<b>Version</b>	Singleturn

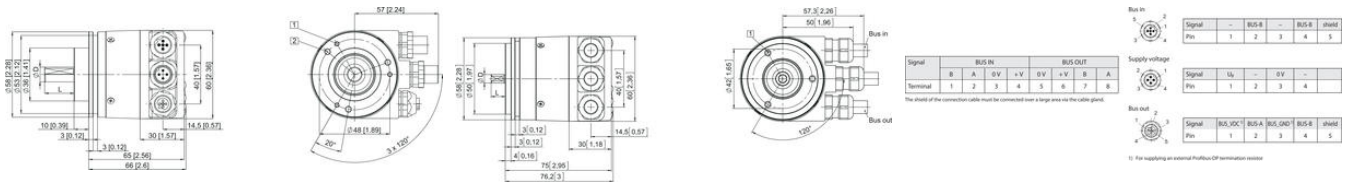

1) For supplying an external Profibus-DP termination resistor