

**KUEBLER - ABSOLUTE-CODED  
 ANGULAR TRANSMITTER SENDIX M3668  
 / M3688, MAGNETIC, CANOPEN, Ø36 MM  
 SERIE M3668**



- Housing diameter Ø36 mm
- CANopen
- New multicolor technology
- IP67

**PRODUCT DESCRIPTION**

Please refer to the images below for ordering information.

<b>Order code</b>	<b>8.M3668</b>	<b>XX</b>	<b>2X</b>	<b>21</b>	<b>22</b>
<b>Shaft version</b>	Type	a	b	c	d

**a Flange**

1 = clamping flange, IP67, ø 36 mm [1.42"]

3 = clamping flange, IP65, ø 36 mm [1.42"]

2 = synchro flange, IP67, ø 36 mm [1.42"]

**4 = synchro flange, IP65, ø 36 mm [1.42"]**

**b Shaft (ø x L), with flat**

1 = ø 6 x 12.5 mm [0.24 x 0.49"]

**3 = ø 8 x 15 mm [0.32 x 0.59"]**

5 = ø 10 x 20 mm [0.39 x 0.79"]

2 = ø 1/4" x 12.5 mm [0.49"]

**c Interface / power supply**

**2 = CANopen DS301 V4.2 / 10 ... 30 V DC**

**d Type of connection**

1 = axial cable, 1 m [3.28'] PVC

A = axial cable, special length PVC \*)

2 = radial cable, 1 m [3.28'] PVC

B = radial cable, special length PVC \*)

3 = axial M12 connector, 5-pin

**4 = radial M12 connector, 5-pin**

\*) Available special lengths (connection types A, B):  
 2, 3, 5, 8, 10, 15 m [5.56, 9.84, 16.40, 26.25, 32.80, 49.21']  
 order code expansion .XXXX = length in dm  
 ex.: 8.M3668.432A.2122.0030 (for cable length 3 m)

**e Fieldbus profile**

**21 = CANopen**

*Optional on request*

- Ex 2/22 (only for connection types 3 and 4)
- surface protection salt spray tested

<b>Order code</b>	<b>8.M3688</b>	<b>XX</b>	<b>2X</b>	<b>21</b>	<b>22</b>
<b>Hollow shaft</b>	Type	a	b	c	d

**a Flange**

**2 = with stator coupling, IP65, ø 46 mm [1.81"]**

3 = with spring element, long, IP65

5 = with stator coupling, IP67, ø 46 mm [1.81"]

6 = with spring element, long, IP67

**b Blind hollow shaft**  
 (insertion depth max. 18.5 mm [0.73"])

1 = ø 6 mm [0.24"]

3 = ø 8 mm [0.32"]

**4 = ø 10 mm [0.39"]**

2 = ø 1/4"

**c Interface / power supply**

**2 = CANopen DS301 V4.2 / 10 ... 30 V DC**

**d Type of connection**

1 = axial cable, 1 m [3.28'] PVC

A = axial cable, special length PVC \*)

2 = radial cable, 1 m [3.28'] PVC

B = radial cable, special length PVC \*)

3 = axial M12 connector, 5-pin

**4 = radial M12 connector, 5-pin**

\*) Available special lengths (connection types A, B):  
 2, 3, 5, 8, 10, 15 m [5.56, 9.84, 16.40, 26.25, 32.80, 49.21']  
 order code expansion .XXXX = length in dm  
 ex.: 8.M3688.242A.2122.0030 (for cable length 3 m)

**e Fieldbus profile**

**21 = CANopen**

*Optional on request*

- Ex 2/22 (only for connection types 3 and 4)
- surface protection salt spray tested

**TECHNICAL DATA**

<b>Connection</b>	Cable, M12
<b>Housing diameter</b>	36 mm

<b>IP class</b>	IP65, IP67
<b>Mounting</b>	Shoulder
<b>Output</b>	CANopen
<b>Resolution MT</b>	24 bit
<b>Sensor type</b>	Absolute
<b>Shaft diameter max</b>	10 mm
<b>Shaft diameter min</b>	6 mm
<b>Supply voltage dc max</b>	30 V DC
<b>Supply voltage dc min</b>	10 V DC
<b>Temperature operational max</b>	85 °C
<b>Temperature operational min</b>	-40 °C
<b>Version</b>	Multiturn

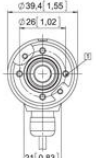
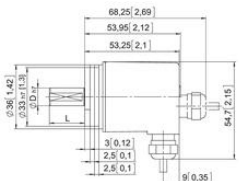
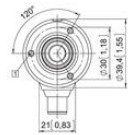
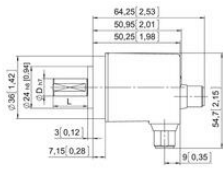

Interface	Type of connector	Cable (isolate unused wires individually before initial start-up)	Signal	V+	0 V	CAN_GND	CAN_H	CAN_L
2	1, 2, A, B		Signal	V+	0 V	CAN_GND	CAN_H	CAN_L
		Cable colour	BN	WH	GY	GN	YE	



Interface	Type of connector	Cable (isolate unused wires individually before initial start-up)	Signal	V+	0 V	CAN_GND	CAN_H	CAN_L
2	1, 2, A, B		Signal	V+	0 V	CAN_GND	CAN_H	CAN_L
		Cable colour	BN	WH	GY	GN	YE	



Interface	Type of connector	M12 connector, 5-pin	Signal	V+	0 V	CAN_GND	CAN_H	CAN_L
2	3, 4		Pin	2	3	1	4	5

