

## ISO - INSULATORS

ISO2000

ISO 15M4UL V0 Insulator 15mm, M4

- Black insulators in polyamide
- Polyamide reinforced with fiberglass
- Molded by injection
- Rated voltage 1000 V ac/1500 V dc
- Working temperature -40 to 130°C

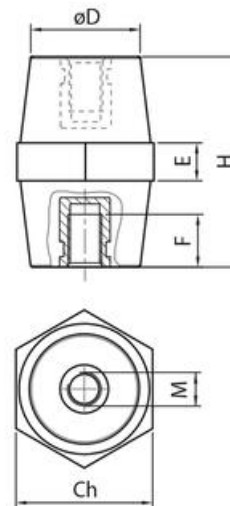

### PRODUCT DESCRIPTION

The "stand off" insulator is used as an insulating support for active conductors to guarantee excellent electrical insulation capability; it can be used as a support for electrical devices, giving high mechanical resistance values, as well as a spacing and/or stiffening element of a system made of conductor bars (copper and/or aluminium).

The various heights, widths and sizes of the threaded inserts make it possible to select the most suitable reference for the specific installation.

The range offers two product types, both with high electrical insulation and mechanical resistance characteristics, obtained using different production processes and materials.

- COMPRHEX: red insulators and spacing columns made of polyester reinforced with fiberglass, molded by compression.
- ISO: black insulators and spacing columns made of polyamide reinforced with fiberglass, molded by injection.

Both ranges of have passed severe tests to check their mechanical and electrical resistance.  
The values obtained during the tests are indicated in the relevant technical tables.

Tests are carried out in compliance with standards EN 60664-1 and EN 61439-1

## TECHNICAL DATA

### GENERAL DATA

Weight	0,005 kg
H (height)	15 mm
Colour	Black
Operating temperature	-40 to 130°C
Nominal torque	3 Nm

<b>Insulation</b>	Polyamide 65 reinforced with 30% fiberglass, Halogen Free
<b>Rated voltage</b>	1000 V AC/1500 V DC
<b>D (Diameter)</b>	12 mm
<b>Material</b>	Polyamide
<b>Compressive strength</b>	1500 daN
<b>Thread size</b>	M4
<b>Flexual strength</b>	100 daN
<b>E (Spanner Height)</b>	3 mm
<b>Tensile strength</b>	150 daN
<b>F (Insert Depth)</b>	5 mm

