

MINIMOTOR - AMSS - STAINLESS STEEL SERVO MOTOR

AMSS 55/50
230V 3000rpm 0.3 Nm

- Stainless steel IP69K construction
- Fitted with 2.5m cables
- Up to 2.35Nm rated torque
- Models with gearbox fitted available - see related products



PRODUCT DESCRIPTION

Motor only

Stainless steel brushless servomotor, AMSS series compliant with EHEDguidelines for hygiene.
4-pole sinusoidal brushless motor, closed form in stainless steel with smooth finish.

Rotor with NdFeB magnets. Thermal cutoff. ClassH insulation winding.
IP69K protection in compliance with IEC/EN60529 standards.

2-Pole resolver feedback.
Roller bearings with reduced backlash and special grease for high temperatures.

[Please click here for 2D and 3D drawings](#)

TECHNICAL DATA

Input voltage ac	230V 50Hz
IP class	IP69K
Nominal speed	3000 rpm
Nominal torque	0,3 Nm
Output power	94 W
Rated current	0,67 A
Starting torque	1,5 Nm

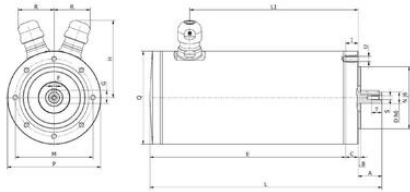

Type	A	B	C	D	E	F	G	H	I	L	L1	M	N	P	Q	R	S	T	U	Peak Output Power (kg)
AMS0000	23	2,5	12	11	184	4	12,5	47,5	8	219	157,5	75	60	90	68	33,5	MA	10	MS	4,04
AMS0000	23	2,5	12	11	189	4	12,5	60,5	12	224	162,5	75	60	90	90	33,5	MA	10	MS	6,30
AMS0000	23	2,5	12	11	239	4	12,5	60,5	12	274	212,5	75	60	90	90	33,5	MA	10	MS	8,30
AMS010M	40	3	16	19	242	6	21,5	76	14	298	219,5	100	80	120	120	33,5	MS	16	MS	11,40

2D model selection

Please see product description above for 2D and 3D drawings

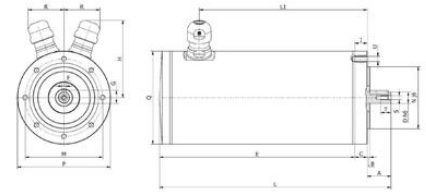

Type	A	B	C	D	E	F	G	H	I	L	L1	M	N	P	Q	R	S	T	U	Peak Output Power (kg)
AMS0000	23	2,5	12	11	184	4	12,5	47,5	8	219	157,5	75	60	90	68	33,5	MA	10	MS	4,04
AMS0000	23	2,5	12	11	189	4	12,5	60,5	12	224	162,5	75	60	90	90	33,5	MA	10	MS	6,30
AMS0000	23	2,5	12	11	239	4	12,5	60,5	12	274	212,5	75	60	90	90	33,5	MA	10	MS	8,30
AMS010M	40	3	16	19	242	6	21,5	76	14	298	219,5	100	80	120	120	33,5	MS	16	MS	11,40

2D model selection

Please see product description above for 2D and 3D drawings