

## CROUZET - GNA SERIES SOLID STATE RELAY

Panel Mount - AC Output Single Phase

84137910N  
SSR 25A 24-280 VAC Out 4-32 VDC In ZC

- Zero cross switching
- Output current 25 - 90 Amps
- Cost effective solution
- LED input status indicator



### PRODUCT DESCRIPTION

### TECHNICAL DATA

#### OVERVIEW

Output current	25 A
Output voltage	24-280V ac
Control voltage	4-32V dc
Mounting	Panel mount
Type of control	Zero voltage turn on

#### OUTPUT SPECIFICATION

Output voltage	24-280V ac
Maximum Load Current	25 A rms
Minimum Load Current	5 mA rms
Transient Voltage	600 V pk
Maximum off-state leakage current	1 mA rms
1 Second surge current	100
Maximum 1 cycle surge current	270/284 (min) 340 (typ)
Maximum on-state voltage drop	1.22V
Thermal resistance junction to case	1,7 °C/W

Maximum 1/2 Cycle I <sup>2</sup> t for fusing (A <sup>2</sup> sec)	487
Minimum heat sink for rated current @ 40 °C	1,3 °C/W
Number of poles	1

## INPUT SPECIFICATION

Control voltage	4-32V dc
Maximum reverse voltage	-32V dc
Minimum turn-on voltage	3V dc
Must turn-off voltage	1V dc
Input current min	10 mA
Input Current Max	14 mA
Maximum turn-on time (ms)	1/2 Cycle
Maximum turn-off time (ms)	1/2 Cycle

## GENERAL SPECIFICATION

Dielectric strength input to output (50/60Hz)	4000 V rms
Ambient operating temperature	-40 ... +80°C
Ambient storage temperature	-40 ... +100°C
Weight	80 g
Height	59,4 mm
Width	44,5 mm
Depth	29,1 mm
Housing material	UL94 V-0
Material base	Aluminium
LED input status indicator	Green
Approvals	CE, cRUus, VDE

GNA Series DC control / Triac 25 A

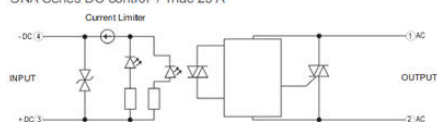

Input current vs Input Voltage  
Standard Regulated DC inputs

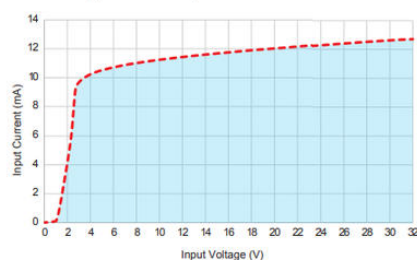

GNA - 25 A

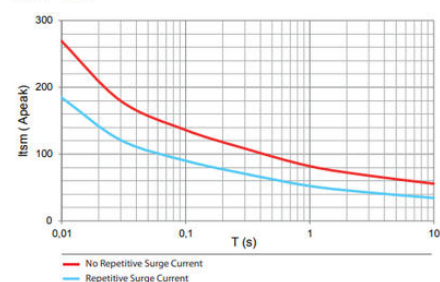

# GNA - 25 A

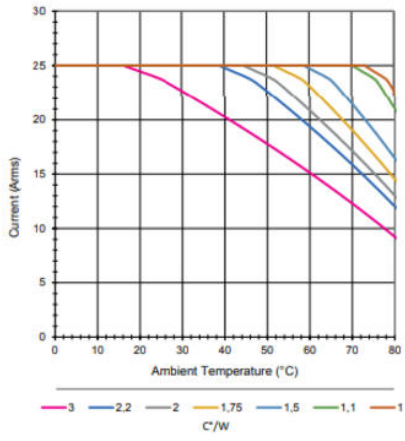

# GNA

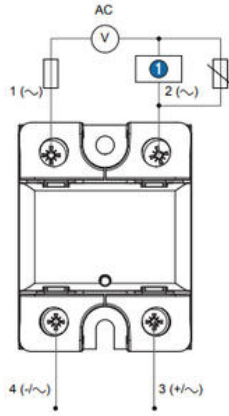

GNA front view

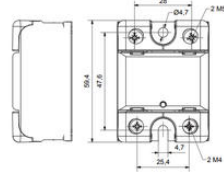

GNA side view

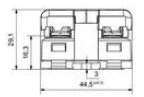

Recommended overvoltage external protection: TVS Diode

1 Load