

CROUZET - GNAD SERIES SOLID STATE RELAY

Panel Mount - DC Output

84137650N
SSR 10A 5-200 VDC Out 4-32 VDC In

- DC switching
- Output current 10 - 40 Amps
- Cost effective solution
- LED input status indicator



PRODUCT DESCRIPTION

TECHNICAL DATA

OVERVIEW

Output current	10 A
Output voltage	5-200V dc
Control voltage	4-32V dc
Mounting	Panel mount
Type of control	DC Switching

OUTPUT SPECIFICATION

Output voltage	5-200V dc
Maximum Load Current	10 A rms
Minimum Load Current	5 mA rms
Transient Voltage	200 V pk
Maximum off-state leakage current	3 mA rms
Maximum on-state voltage drop	0.97V pk
Thermal resistance junction to case	0,66 °C/W
Minimum heat sink for rated current @ 40 °C	3,1 °C/W
Number of poles	1

INPUT SPECIFICATION

Control voltage	4-32V dc
Maximum reverse voltage	-32V dc
Minimum turn-on voltage	3.5V dc
Must turn-off voltage	1V dc
Input current min	34 mA
Input Current Max	35 mA
Maximum turn-on time (ms)	0.02
Maximum turn-off time (ms)	0.02

GENERAL SPECIFICATION

Ambient operating temperature	-25 ... +90°C
Ambient storage temperature	-40 ... +100°C
Weight	80 g
Height	59,4 mm
Width	44,5 mm
Depth	29,1 mm
Housing material	UL94 V-0
Material base	Aluminium
LED input status indicator	Green
Approvals	CE, cRUus

Input current vs Input Voltage
Standard Regulated DC inputs

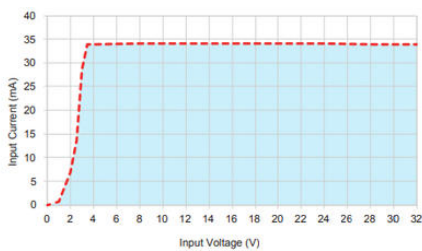

GNAD - 10 A

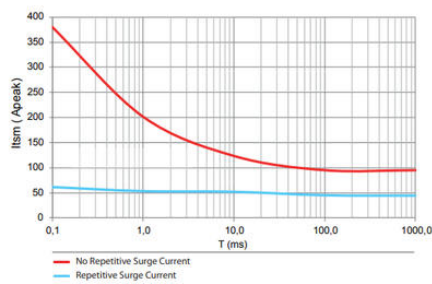

GNAD - 10 A

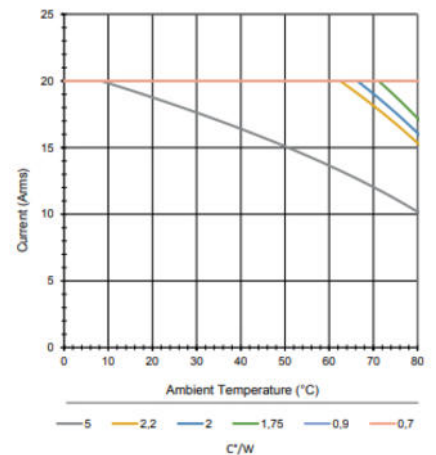

GNAD Series DC control

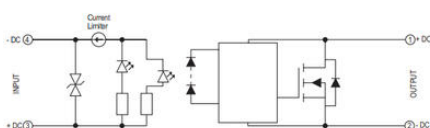

GNAD front view

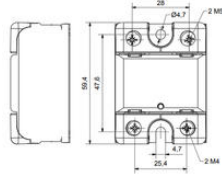

GNAD side view

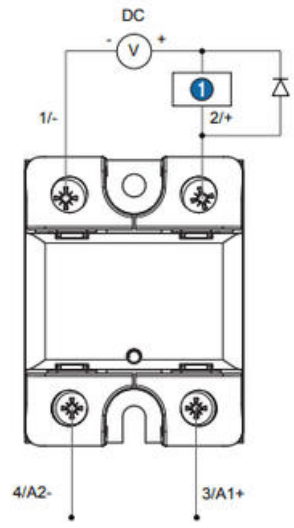

GNAD

1 Load