

## CROUZET - GNA SERIES SOLID STATE RELAY

Panel Mount - AC Output Single Phase

84137910N  
 SSR 25A 24-280 VAC Out 4-32 VDC In ZC

- Zero cross switching
- Output current 25 - 90 Amps
- Cost effective solution
- LED input status indicator



### PRODUCT DESCRIPTION

### TECHNICAL DATA

#### OVERVIEW

<b>Mounting</b>	Panel mount
<b>Type of control</b>	Zero voltage turn on
<b>Output current</b>	25 A
<b>Control voltage</b>	4-32V dc
<b>Output voltage</b>	24-280V ac

#### OUTPUT SPECIFICATION

<b>Transient Voltage</b>	600 V pk
<b>Maximum off-state leakage current</b>	1 mA rms
<b>Minimum Load Current</b>	5 mA rms
<b>Maximum 1 cycle surge current</b>	270/284 (min) 340 (typ)
<b>Thermal resistance junction to case</b>	1,7 °C/W
<b>1 Second surge current</b>	100
<b>Number of poles</b>	1
<b>Maximum Load Current</b>	25 A rms
<b>Output voltage</b>	24-280V ac

Maximum 1/2 Cycle I <sup>2</sup> t for fusing (A <sup>2</sup> sec)	487
Minimum heat sink for rated current @ 40 °C	1,3 °C/W
Maximum on-state voltage drop	1.22V

## INPUT SPECIFICATION

Input Current Max	14 mA
Minimum turn-on voltage	3V dc
Maximum turn-off time (ms)	1/2 Cycle
Input current min	10 mA
Maximum turn-on time (ms)	1/2 Cycle
Must turn-off voltage	1V dc
Maximum reverse voltage	-32V dc
Control voltage	4-32V dc

## GENERAL SPECIFICATION

Depth	29,1 mm
Weight	80 g
Ambient operating temperature	-40 ... +80°C
Dielectric strength input to output (50/60Hz)	4000 V rms
Width	44,5 mm
LED input status indicator	Green
Housing material	UL94 V-0
Ambient storage temperature	-40 ... +100°C
Material base	Aluminium
Approvals	CE, cRUus, VDE
Height	59,4 mm

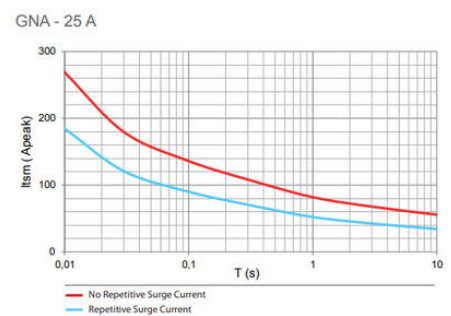
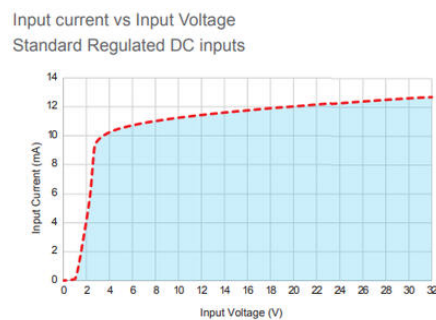
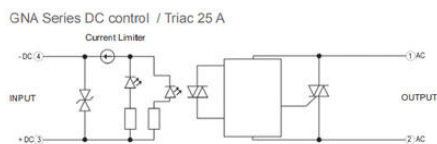

# GNA - 25 A

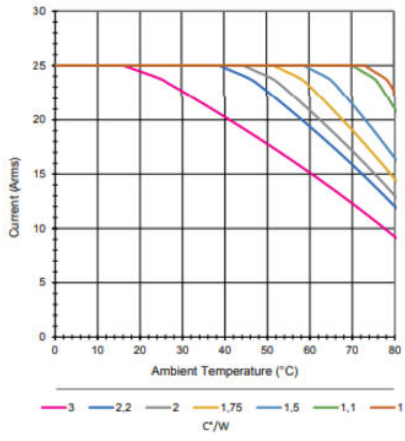

# GNA

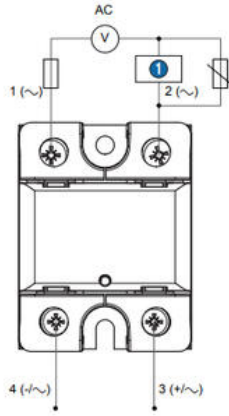

GNA front view

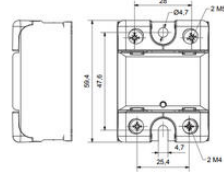

GNA side view

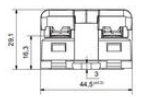

Recommended overvoltage external protection: TVS Diode

① Load