



## VARIOLINE LAMP WITH SOCKET LED 121/122 - OBSOLETE - NEW RANGE COMING SOON

Varioline

12227.0-00

OBSOLETE - LED 122 220-240V AC, door switch,  
screw fixing, Australia socket

- OBSOLETE
- FOR LED LIGHT USE LED 025
- FOR SOCKETS USE SD 035



### PRODUCT DESCRIPTION

LED 121/122 Range is now Obsolete - Stego has a New Range coming Mid 2024

## TECHNICAL DATA

### GENERAL DATA

Mounting	Screw fixing
Nominal voltage	220-240 V AC
Activation	Door switch
Connection type	3-pole plug with snap lock
Socket	AUS
Nominal socket current	10 A
Light source	LED
Luminance	1.080 Lm/1.730 Lm
Life span	60,000h at +20°C

### DIMENSIONS

Length	700 mm
Width	100 mm
Height	44 mm

## ELECTRICAL SPECIFICATION

Frequency	50/60 Hz
Power consumption	16 W

## SAFETY & APPROVALS

Protection class	I (earthed)
IP class	IP20
Approvals	CE, RoHS
Approvals pending	VDE

## MATERIALS - CONDITIONS

Material of body	Plastic
Colour	Translucent/White
Operational temperature	-30°C ... +40°C
Storage temperature	-40°C ... +85°C
Operating humidity	< 90% RH
Humidity storage	<90% RH

## ADDITIONAL DATA

Weight	0,4 kg
Voltage max	265 V ac
Voltage min	200 V ac

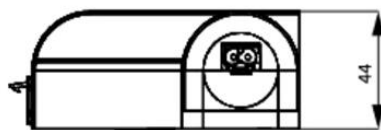
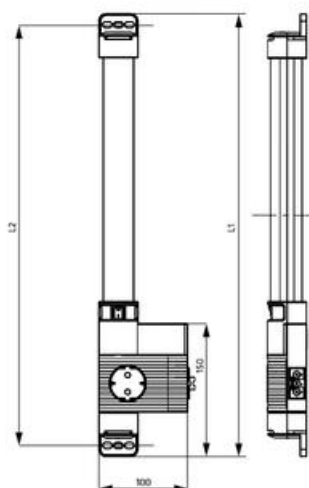

View of screw fixing

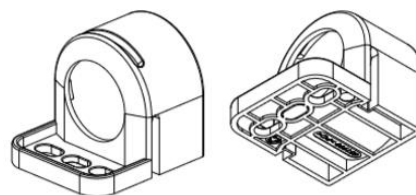

LED 121 (Size 1)  
L1 = 500 mm  
L2 = 475 mm

LED 122 (Size 2)  
L1 = 700 mm  
L2 = 675 mm

